

# ALPHA LITE USER MANUAL BOOK



---

TL SERIES

---

**TL30 FOCUS ZOOM**



## Precautions

[ WARNING ]

---

**1**

Do not open or disassemble the cover to reduce the risk of electric shock.

---

---

**2**

Please wear safety equipment such as safety helmet during work.

---

---

**3**

Please install the signs below for people to bypass when install the product on high truss.

---

---

**4**

The work should be done under the direction of approved specialist who is trained in safety and mechanical installations.

---

---

**5**

The brightness and color temperature before and after aging may be different.

---

# Contents

Safety Information .....	1
--------------------------	---

## Fixture Information

Fixture Information .....	3
Fixture Exterior View .....	4
Dimensions .....	5
Technical Specifications .....	6

## Connection and Setting

Connection (Only in 6-way adapter) .....	7
Address Setting (Only in 6-way adapter) ...	8



Product name.

---

# TL30 FOCUS ZOOM

---

- ⇒ Average CRI 96 or higher
  - ⇒ COB LED Chip
  - ⇒ Adjust the angle freely
  - ⇒ 4-way / 6-way adapter can be selected.
  - ⇒ Dimming and RDM network communication is possible through LED TL Controller (6-way only).
  - ⇒ Maintain the last signal when DMX signal is lost
-

## Fixture Exterior View



## Dimensions

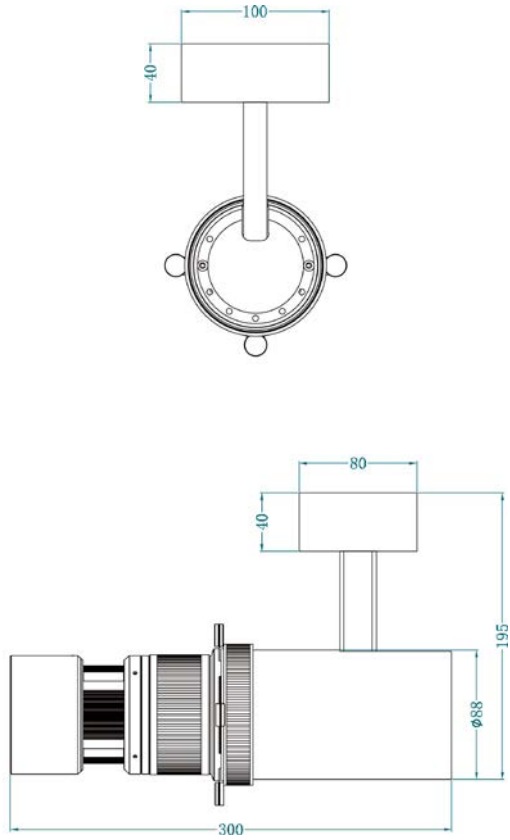

## Technical Specifications

<b>LED Chip Type</b>	32W
<b>Estimated LED Lifetime (hours)</b>	50,000
<b>White Light (K)</b>	5600
<b>Color Rendition (%)</b>	97
<b>(Optional) Dimming with TL Controller (%)</b>	0~100 (Only in 6-way adapter)
<b>Beam Angle ( ° )</b>	5~20 Shapable Round / Square / Rectangle
<b>Signal Control</b>	6 way Track rail DMX
<b>(Optional) Individual Control</b>	Dip Switch
<b>(Optional) Supported Protocol</b>	DMX512 with Controller
<b>Remote Device Management</b>	Not Supported
<b>Channel Function</b>	Dimming
<b>Track Adapter</b>	4-way / (Option) 6-way
<b>Power Input Voltage</b>	AC 200-240V
<b>Power Consumption (W)</b>	28.8
<b>Body Dimensions (mm/inch) (DIA x L)</b>	ø88 x 300
<b>Body Weight (kg/lbs)</b>	2 / 4.4

\* This specification data is based on the aging state of the equipment, and the brightness and color temperature before and after aging may be different .

# Connection (Only in 6-way adapter)

\*TL30 Image example

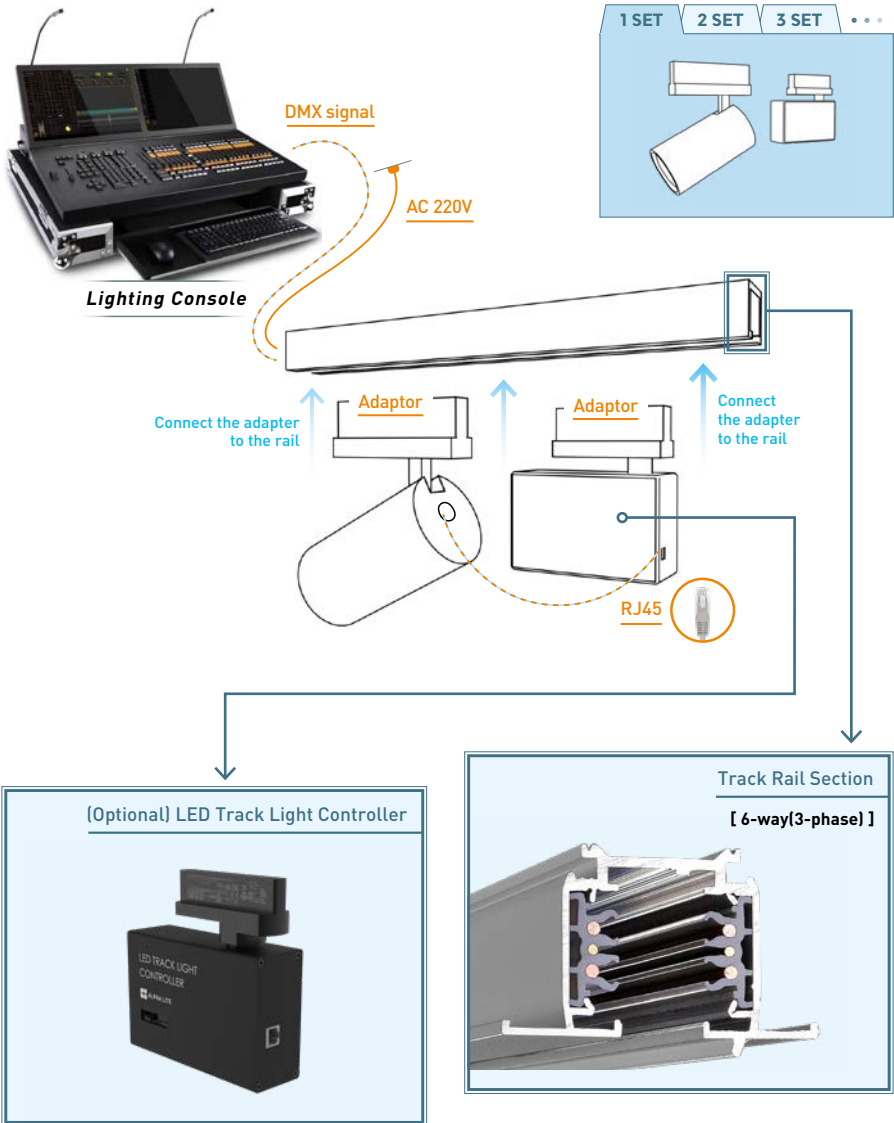



## Address Setting (Only in 6-way adapter)

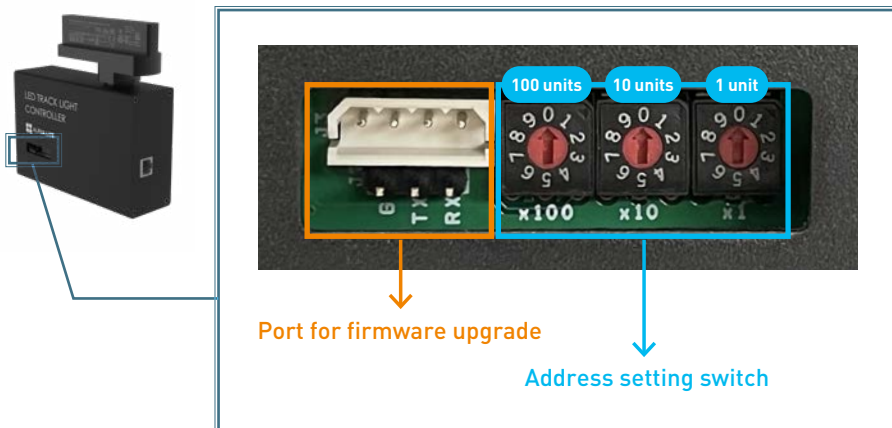

## Address Setting Example

Maximum #512 [Adjust the arrows to set the number]

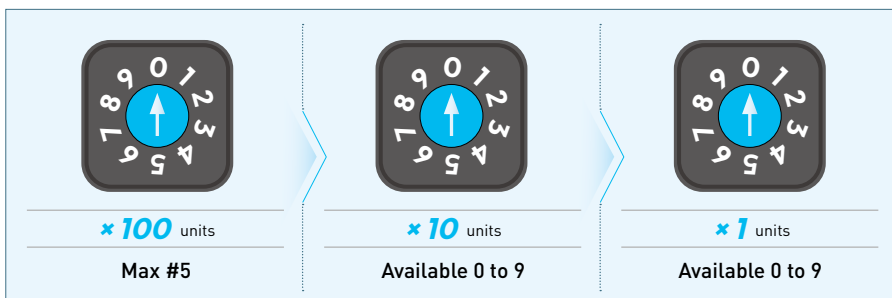



## ALPHA LITE USER MANUAL BOOK

—

<Tel> 82-2-6317-0464

<Fax> 82-2-2039-0464

<E-mail> [hello@alpha-lite.net](mailto:hello@alpha-lite.net)

<Web> [www.alpha-lite.net](http://www.alpha-lite.net)