

ALPHA LITE USER MANUAL BOOK



DESK PAD

DSPAD



Precautions

[WARNING]

1

Do not open or disassemble the cover to reduce the risk of electric shock and product damage.

2

The brightness and color temperature before and after aging may be different.

Contents

Safety Information 1

Fixture Information

Fixture Information 3
Fixture Exterior View 4
Dimensions 5
Accessory Options 6
Side Reflection System 7
Charging and Power Connection

Screen Information

Screen Instruction 8

Setting

Brightness(Intensity) Adjust 9
CCT(Correlated Color Temperature) Adjust 10



Product name.

DSPAD

- ⇒ Flat light source lighting fixture with excellent diffusivity, which is mainly used in broadcast studio
 - ⇒ Installed on the newsroom or desk and used as a lighting for person
 - ⇒ The LED source sets on the side(edge) with reflection and pattern optical technology applied.
 - ⇒ The LED source is not directly visible, no glare and extremely soft light distribution
 - ⇒ No fan and noiseless
 - ⇒ Excellent light quality, and average CRI 95-98 / R9, R12 are CRI 90 or higher
 - ⇒ 2900-6000K color temperature control function
 - ⇒ Built-in battery for easy installation and movement
 - ⇒ Can be used continuously for about 2 hours and 30 minutes without changing the brightness.
-

Fixture Exterior View



Dimensions

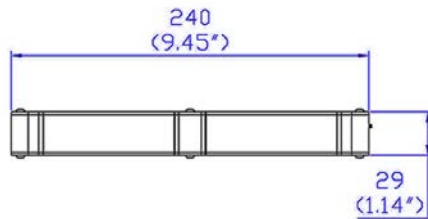
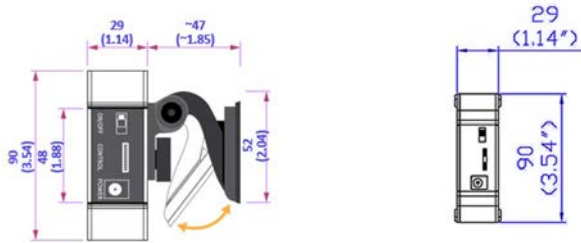
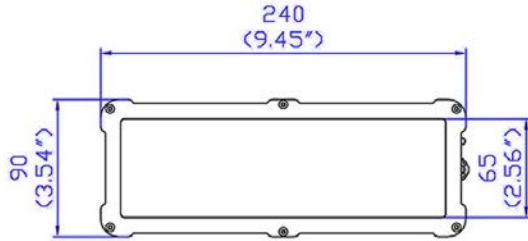

Technical Specifications

| | |
|---|-------------------------------------|
| LED Chip Type | 0.5W 3030 PKG LED + Edge Reflector |
| Estimated LED Lifetime (hours) | 50,000 |
| White Light (K) | 2,900~6,000 (VCT) |
| Color Rendition (%) | CRI 97 / TLCI 97 |
| Dimming (%) | 0~100 (16-bit) |
| Light Aperture Size (mm/inch) | 215 x 65 / 8.5 x 2.5 |
| Beam Angle (°) | 135 |
| Individual Control | Swich Jog Controller / OLED Display |
| Function | Dimming / CCT |
| Power Input Voltage | 12.6V DC |
| Lighting Time (Battery) | 2.5 hours |
| Power Consumption (W) | 18 |
| Ambient Temperature Operation (°C) | -20~45 |
| Body Dimensions (mm/inch) (WHD) | 240 x 90 x 29 / 9.5 x 3.5 x 1.1 |
| Body Weight (kg/lbs) | 0.8 / 1.8 |
| Protection Class | IP20 |

* This specification data is based on the aging state of the equipment, and the brightness and color temperature before and after aging may be different .

Side Reflection System

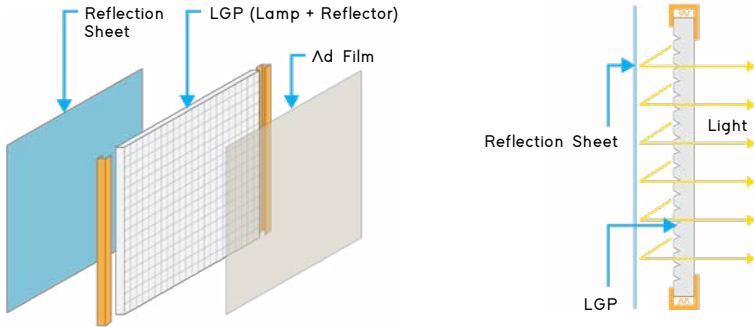

Charging and Power Connection

This fixture requires an external power adapter of 12.6V DC.

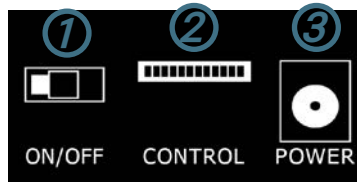

- 1 Power Switch** Turn on and off
- 2 Jog Switch** Menu switching, brightness and color temperature can be adjusted.
- 3 Power Input** Connect the 12.6V power supply to charge the device. It can be used with the power adapter connected.

- ⚠ WARNING**
1. Please make sure to use correct voltage range.
 2. If the operating voltage is outside the correct voltage range, the function of the fixture may be degraded or damaged.
 3. Be sure to use the supplied power adapter.

Screen Instruction

How to change the screen

The menu screen changes each time press the jog.

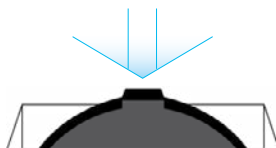

→ Start Screen

Visible screen at start up.

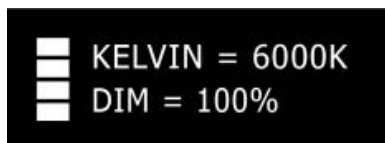

⌂ Current Status Screen

Current battery status (25% each, 4 bars), color temperature value (KELVIN), light brightness value [%] are displayed. Press the jog switch to go to 'Brightness setting' screen.



☀ Brightness Adjustment Screen

Current battery status (25% each, 4 bars) and the light brightness value are displayed, and the value [%] can be adjusted with the jog switch. Press the jog switch to go to the 'Color temperature setting' screen.

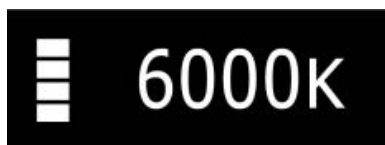

🌈 CCT Adjustment Screen

Current battery status (25% each, 4 bars) and the lighting color temperature value are displayed, and the value (Kelvin) can be adjusted with the jog switch. Press the jog switch to go to the 'Current Status' screen.

Brightness (Intensity) Adjust

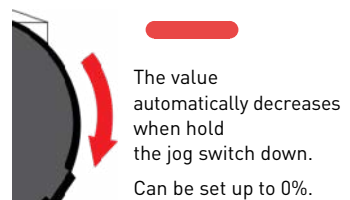
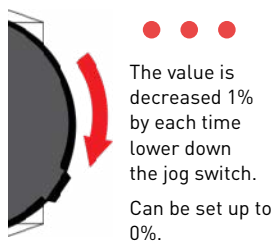
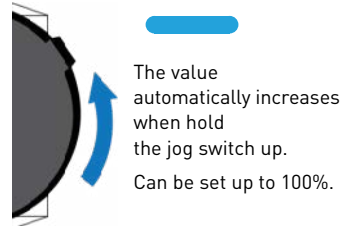
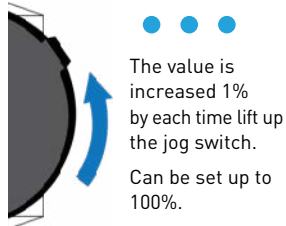
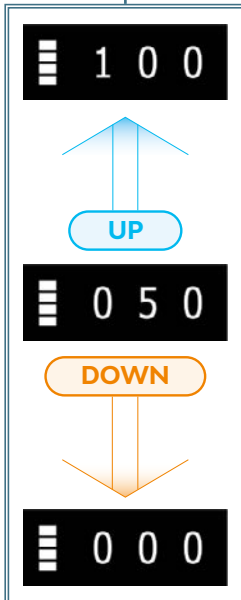
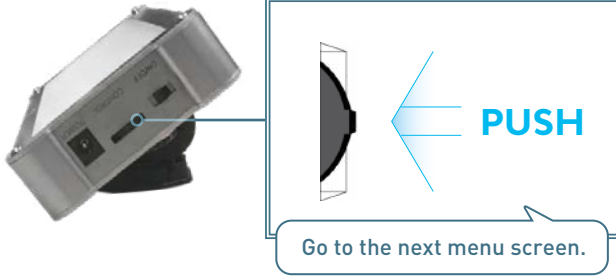

CCT (Correlated Color Temperature) Adjust

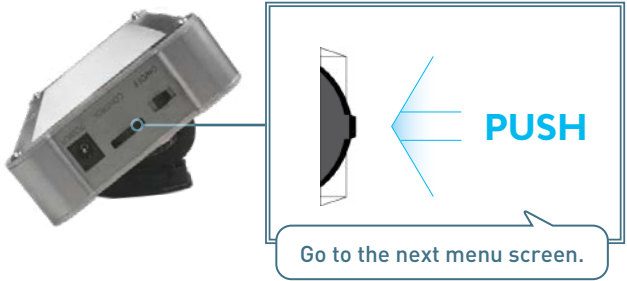

6000K

UP

4550K

DOWN

2900K

The value is increased 50K by each time lift up the jog switch. Can be set up to 6,000K.

The value automatically increases when hold the jog switch up. Can be set up to 6,000K.

The value is decreased 50K by each time lower down the jog switch. Can be set up to 2,900K.

The value automatically decreases when hold the jog switch down. Can be set up to 2,900K.



ALPHA LITE USER MANUAL BOOK

—

<Tel> 82-2-6317-0464

<Fax> 82-2-2039-0464

<E-mail> hello@alpha-lite.net

<Web> www.alpha-lite.net